

**xiaomi**

Humidifier 2 Lite User Manual



Read this manual carefully before use, and retain it for future reference.

- This appliance can be used by children aged from 8 years and above and persons with reduced physical, sensory or mental capabilities or lack of experience and knowledge if they have been given supervision or instruction concerning use of the appliance in a safe way and understand the hazards involved. Children shall not play with the appliance. Cleaning and user maintenance shall not be made by children without supervision.

- This appliance is not intended for use by persons (including children) with reduced physical, sensory or mental capabilities, or lack of experience and knowledge, unless they have been given supervision or instruction concerning use of the appliance by a person responsible for their safety.

If the supply cord is damaged, it must be replaced by the manufacturer, its service agent or similarly qualified persons in order to avoid a hazard.



Clean the water tank every 3 days.

Be aware that high humidity levels may encourage the growth of biological organisms in the environment.

- Do not permit the area around the humidifier to become damp or wet. If dampness occurs, turn the output of the humidifier down. If the humidifier output volume cannot be turned down, use the humidifier intermittently. Do not allow absorbent materials, such as carpeting, curtains, drapes, or tablecloths, to become damp.
- Unplug the appliance during filling and cleaning.
- Never leave water in the reservoir when the appliance is not in use.
- Empty and clean the humidifier before storage. Clean the humidifier before next use.
- Empty the water tank and refill every third day. Before refilling, clean it with fresh tap water or cleaning agents if required by the manufacturer. Remove any scale, deposits, or film that has formed on the sides of the water tank or on interior surfaces, and wipe all surfaces dry.
- **WARNING:** Micro-organisms that may be present in the water or in the environment where the appliance is used or stored, can grow in the reservoir and be blown in the air causing very serious health risks when the water is not renewed and the tank is not cleaned properly every 3 days.
- Do not plug in or unplug the humidifier with wet hands so as to avoid the risk of electric shocks.
- Do not attempt to disassemble, repair, or modify the humidifier by yourself.

- Do not touch the vaporizer once the humidifier is turned on. Otherwise, you may feel a sting.
- Do not tangle, damage, or place heavy objects on the power cord so as to avoid the risk of electric shocks, short circuits, or fire.
- Immediately unplug the humidifier if there is an error during use, and contact after-sales service team.
- During the working of the humidifier, do not remove the water tank from the base, and never touch the water conduits or any components inside the reservoir.
- Unplug the humidifier during thunderstorms or when you do not plan to use it for an extended period of time.
- Do not turn the humidifier upside down when it is working or there is water in the tank so as to avoid damage to the internal electronic components. Please strictly follow the instructions in this user manual
- when using the humidifier. Users are responsible for any loss or damage that may arise from improper use of the humidifier.

# Product Overview

---

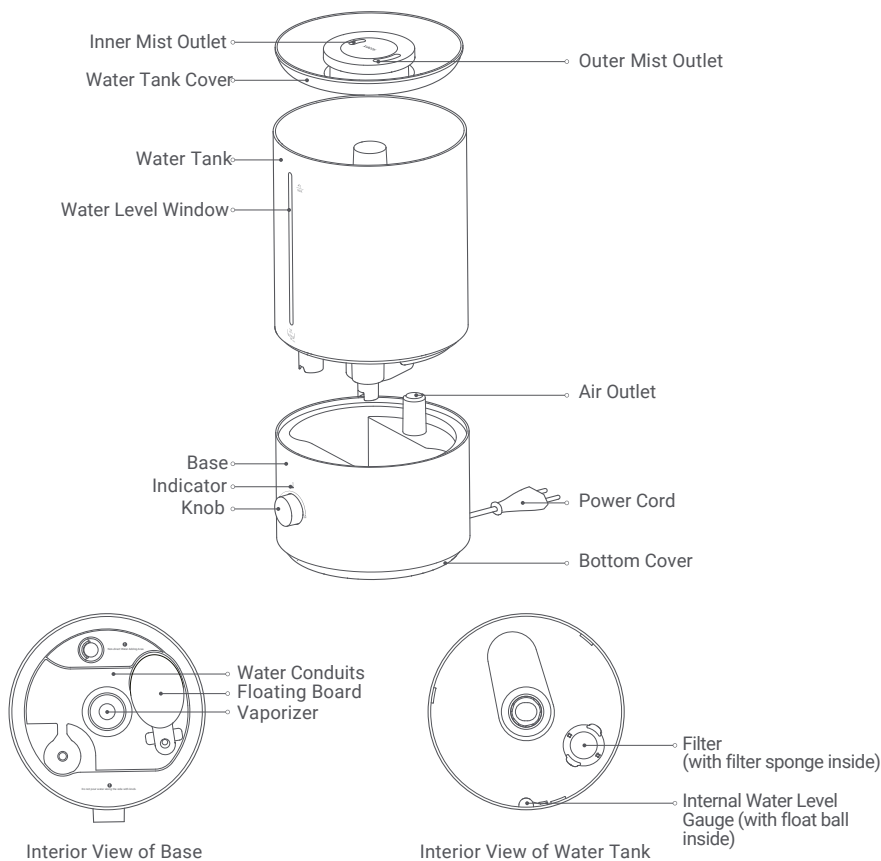

Note: Illustrations of product, accessories, and user interface in the user manual are for reference purposes only. Actual product and functions may vary due to product enhancements.

# How to Use

---

- Water Adding

It is recommended to add clean tap water or purified water in the following three methods:

Method 1: Add an appropriate amount of water to the water tank from the hollow part of the water tank cover.

Method 2: Open the water tank cover to add water to the water tank.

Method 3: Remove the water tank and place it on a level surface, then add water to the water tank. Or you can directly carry the water tank to a faucet, and add water after cleaning the tank.

CAUTION: Ensure that the humidifier is placed on a level surface and the water does not exceed the maximum water level.

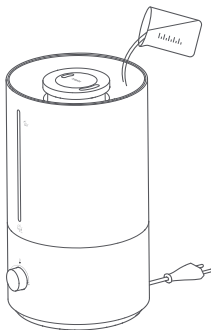

Method 1

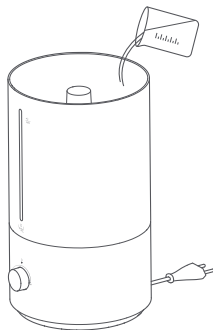

Method 2

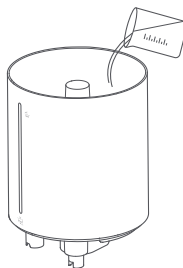

Method 3

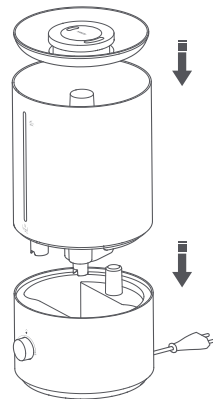

Installing

- Connecting to Power: Plug the humidifier into an electrical outlet that meets the humidifier's requirements to connect to power.
- Turning on: Rotate the knob clockwise.
- Turning off: Rotate the knob counterclockwise to "OFF".
- Adjusting the Mist Volume: Rotate the knob clockwise to increase the mist volume, and rotate the knob counterclockwise to decrease it.

- Indicator Status Descriptions

Humidifier	Indicator
Working normally	White
Insufficient water	Red
Water tank removed	Red
Off	Off

## Precautions

### Installing the Humidifier

- To avoid electric shocks, fires, personal injury, or other damage, make sure the humidifier is properly used. Do not connect the humidifier to the electrical outlet until it is fully assembled.
- Do not disassemble the humidifier.

### Moving the Humidifier

- Turn off and unplug the humidifier before moving it.
- When transporting or moving the humidifier, empty the water tank first.

### Placing the Humidifier

- When using the humidifier for the first time in a new environment, leave it at room temperature for 30 minutes before use; otherwise, the water tank may be damaged due to sudden temperature changes.
- Do not place the humidifier directly on wooden surfaces to prevent surfaces from being damaged or deformed caused by moisture.
- Do not place the humidifier within a distance of two meters from furniture and appliances to protect furniture and appliances from moisture.
- Keep the humidifier away from heat sources and avoid exposing it to direct sunlight.

- Empty the water tank before placing it separately.
- Do not use the humidifier on a blanket or towel to avoid blocking the air inlet and wetting the table.

### Water Tank

- Do not add water over 40°C into the water tank to avoid damage to the humidifier.
- Do not add water through the mist outlets.
- When there is water at the bottom of the humidifier, wipe the water off with a dry cloth to avoid damaging the humidifier.
- Do not use the humidifier in environments where the temperature is below 0°C, as the water in the water tank may freeze and cause damage to the humidifier. Always empty the water out of the water tank in such environments. Do not place any metal objects, chemicals, or detergent into the water tank when the humidifier is in use;
- otherwise, the humidifier will be damaged and air quality will deteriorate. Always turn off and unplug the humidifier before emptying the water tank.
- 

### Using the Humidifier

- Immediately stop using the humidifier if it makes unusual sounds, gives off bad odors, or overheats.
- Keep hair and fabrics away from the humidifier to prevent them from being caught in or blocking the air inlet and the air outlet.
- Do not sit on, lean on or tilt the humidifier.
- When using the humidifier in conjunction with gas-fueled appliances, such as gas stoves and gas heaters, make sure there is sufficient ventilation to avoid carbon monoxide poisoning.

### Usage Restrictions

Follow the instructions below to avoid electric shocks, fires, or other

~~damages~~ place the humidifier on a level surface. Otherwise, the water level reading may be incorrect or the water tank may overflow.

- The voltage of the power source must be the same as the rated voltage of the humidifier. Do not use the humidifier if the voltages do not match.



## Care & Maintenance

---

- Always turn off and unplug the humidifier before cleaning it.
- The humidifier can be wiped directly with a clean, soft, and damp cloth, and it is recommended to clean it once a week.
- To remove the scale in the water tank, you can pour citric acid (sold separately) into the tank, wipe off the scale with a cotton swab or soft brush, and then clean the tank with water.
- If the humidifier will not be used for an extended period, pour out the remaining water out of the base and the water tank. Clean and dry all the parts before storing the humidifier.

## Specifications

---

Name: Humidifier

Model: MJJSQ06DY

Rated Voltage: 220–240 V~

Rated Power: 23 W

Rated Frequency: 50/60 Hz

Operating Temperature: 5°C to 40°C

Humidifying Capacity: 300 mL/h \*

Noise:  $\leq 38$  dB(A)

Net Weight: 1.4 kg

Water Tank Capacity: 4 L

Item Dimensions:  $\Phi 190 \times 202 \times 315$

mm Operating Humidity: 10%–80% RH

---

\* The humidifying capacity was tested by CVC Testing Technology Co., Ltd. according to the standard GB/T 23332-2018. The tested mist dispensing angle is 180°. Test Report No.: WTS2022-8608.

## Troubleshooting

Issue	Possible Cause	Solution
The humidifier cannot turn on normally.	The humidifier is not connected to power.	Check if the humidifier is plugged in properly.
	The water is running out in the water tank.	Add water to the water tank.
The humidifier does not generate wind or mist when it is working.	Fan error	Contact the after-sales service team.
	The vaporizer is damaged.	
The mist volume is too small.	The air inlet or the mist outlet is blocked.	Clean the air inlet or the mist outlet.

Note: If you cannot fix the issues with the above solutions, please contact the after-sales service team.

## Regulatory Compliance Information

### WEEE Disposal and Recycling Information



All products bearing this symbol are waste electrical and electronic equipment (WEEE as in directive 2012/19/EU) which should not be mixed with unsorted household waste. Instead, you should protect human health and the environment by handing over your waste equipment to a designated collection point for the recycling of waste electrical and electronic equipment, appointed by the government or local authorities. Correct disposal and recycling will help prevent potential negative consequences to the environment and human health. Please contact the installer or local authorities for more information

about the location as well as terms and conditions of such collection points.

### EU Declaration of Conformity



We, Guangdong Deerma Technology Co., Ltd., hereby declare that this equipment is in compliance with the applicable Directives and European Norms, and amendments. The full text of the EU declaration of conformity is available at the following internet address:

<http://www.mi.com/global/service/support/declaration.html>

For detailed e-manual, please go to [www.mi.com/global/service/userguide](http://www.mi.com/global/service/userguide)

For further information, please go to [www.mi.com](http://www.mi.com)

Manufactured for: Xiaomi Communications Co., Ltd.

Manufactured by: Guangdong Deerma Technology Co., Ltd.

(a Mi Ecosystem company)

Address: No.4-1 Longhui Road, Malong Village Committee, Beijiao Town, Shunde District,  
Foshan City, Guangdong Province, China

Importer:

Beryko s.r.o.

Pod Vinicemi 931/2, 301 00 Plzeň

[www.beryko.cz](http://www.beryko.cz)

